



## 5H Low Profile Casters - Up to 1760lb

- Provide the highest weight capacity at the lowest overall height
- NSF Listed and RoHS Compliant
- Hardened Dual Raceway
- 1/2" grade 8 bolt
- Zinc Plated

5HNX25JB0917YY



5HNX25JB0912YY



### Applications:

Conveyer Stands  
Computer Cabinets

Any equipment where low height is critical while requiring heavy load rating

Plate Code	Overall Size		Bolt Hole Pattern				Mounting Bolt Size	
7X	4" x 4-1/2"		2-13/16" x 3-5/16"				3/8"	
12	3-1/8" x 4-1/8"		2-3/8" x 3-3/8"				5/16"	
Wheel Dia.	Tread Width	Wheel Type	Load Capacity	Bearing Type	Swivel Part #	Rigid Part #	Overall Height	Swivel Radius
2.5"	2"	Ironman™	1760	Caged Roller	5HNX25JB097XYY	6HNX25JB097XYY	3-11/16"	1-3/4"
			1200		5HNX25JB0912YY	6HNX25JB0912YY	3-5/8"	2-1/4"

## LV SERIES

- AC Rubber leveling cushion pad for constant pressure and temperature change
- Rear accessible thumb wheel to adjust the leveling pad
- Aluminum Die-Cast rig, Powder coating finish
- NSF Listed and RoHS Compliant
- Forged Steel Plate, Zinc Plated
- Double Ball Bearings Raceways
- High quality Nylon wheel

### Applications:

Telecom/Broadcasting Console  
LAB/Research Equipment  
Medical Equipment  
Office Business Equipment  
Electronic Equipment  
Food/Retail Equipment  
Conveyer Stands  
Work Stations  
Assembly Machinery



Top plate diagram of ALL 8 sizes, dimension, bolt hole patterns including info of plate and mounting bolt diameter

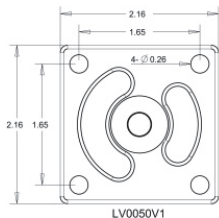

LV0050V1

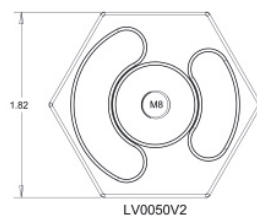

LV0050V2

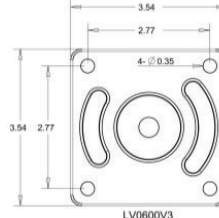

LV0600V3

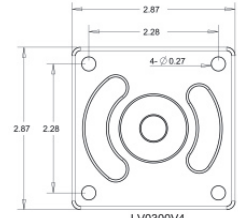

LV0300V4

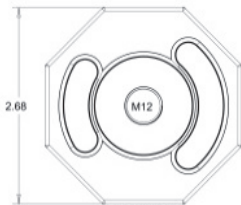

LV0600V4

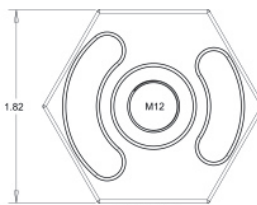

LV0300V5

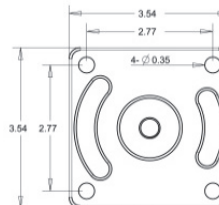

LV1000V6

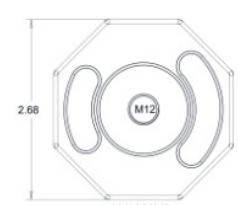

LV1000V7

Wheel Dia.	Tread Width	Wheel Type	Swivel Caster #	Static Load Capacity	Overall Height	Adjustment Range	Fastening Specificaiton	Attaching Bolts Size
42mm(1.65")	18mm(0.71")	Nylon	LV0050V1	110	2.8"	+0.47"	Plate 2.16" SQ. Hole Space 1.65" SQ	1/4"
			LV0050V2				Threaded Hollow Kingpin	M8-1.25
50mm(1.97")	22mm(0.87")		LV0300V4	600	3.23"	+0.47"	Plate 2.87" SQ. Hole space 2.8" SQ	1/4"
			LV0300V5				Threaded Hollow Kingpin	M12-1.75
62mm(2.44")	29mm(1.14")		LV0600V3	1300	4.02"	+0.59"	Plate 3.54" SQ Hole space 2.77" SQ	5/16"
			LV0600V4				Threaded Hollow Kingpin	M12-1.75
72mm(2.83")	31mm(1.22")		LV1000V6	2200	4.72"	+0.79"	Plate 3.54" SQ. Hole Space 2.77" SQ	5/16"
			LV1000V7				Threaded Hollow Kingpin	M12-1.75

## Casters with Adjustable Leveling Foot

- Excellent for moving around heavy equipment when low profile is a main concern
- Broad range of adjustable height with simple choice of the leveling foot
- Easily raise the height by hand or wrench
- NSF Listed and RoHS Compliant

ACM60AF



SLC700F



Part No.	Mounting Bolt	Wheel Dia.	Width	Wheel Material	Overall height	Top Plate	Swivel Radius	Leveling foot	Load Capacity	
									Static	Dynamic
SLC200F	M8	50mm	26mm	Ironman™	72.5mm(2.86")	73mm x 73mm	73mm(2.88")	3/8"-16	660	800
SLC700F	M8	72mm	31mm	Ironman™	100mm(4")	95mm x 95mm	100mm(3.94")	5/8"-11	1500	2200
ACM60AF	M8	75mm	35mm	Ironman™	108mm(4.25")	90mm x 90mm	102mm(4.02")	5/8"-11	1760	2200

## Leveling Foot

LFI5811020



LFI3816002



LFM1213566



Part No.	Thread	Total Length	Dia. of Bottom	Load Capacity
LFI3816002	3/8"	2"	32mm(1.26")	220
LFM1213566	1/2"-13"	2-1/4"	49mm(1.91")	800
LFI3410040	3/4"-10"	4"	45mm(1.77")	2000
LFI5811020	5/8"-11"	4-1/2"	45mm(1.77")	1760

## 5U Low Profile Casters - Up to 1760lb

- Forged 1045 Steel Top Plate, Die casted Aluminum body frame for maximum strength and light weight
- Excellent for moving around heavy equipment when low profile is a main concern
- Provide the high weight capacity at the lowest overall height
- NSF Listed and RoHS Compliant
- Variety of wheel options

5UPU60MM

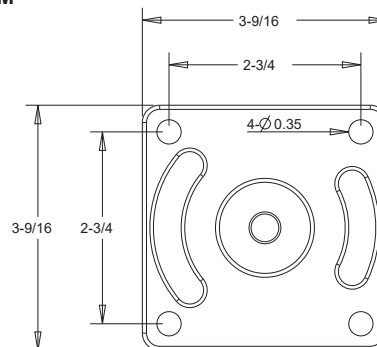

### Applications:

Conveyer Stands  
Computer Cabinets

Wheel Diameter	Tread Width	Wheel Type	Swivel Casters #	Load Capacity	Overall Height	Swivel Radius
60mm(2.36")	50mm(1.97")  24mm x 2 (Dual wheel 0.95" x 2")	PU Shore D 65	5UPU60MM	600	92mm(3.625")	2-1/4"
		Ironman	5UNX60MM	1800		
			5JNX24MM			